

Price : SOLD

5 🏠 2 🚗 3 🚗



- 32 km's South of Narromine  
143.81 Acres (58.196 Ha)  
1923 timber homestead with large veranda's lovingly renovated, set in landscaped gardens with established trees with turf valve watering system - new Colourbond roof and re-stumped 6 years ago.
- 5 bedrooms all carpeted, with 4 bedrooms having built-in wardrobes and ceiling fans
  - Evaporative air-conditioning ducted throughout the house and Cypress polished floorboards
  - Formal dining room with original fireplace, decorative plaster cornice and bi-fold door between the lounge and dining
  - Lounge room which opens onto the kitchen, decorative plaster cornice and Jindara electric fireplace
  - Renovated kitchen with ceramic butlers sink, large custom kitchen island and walk-in pantry
  - Renovated laundry with second shower and toilet, with separate mudroom
  - Stunning sunroom as second living area with split system air conditioning, slow combustion fire and polished floorboards
  - Entertainer's bar with historic timber bar, slow combustion fire, bar fridge and timber panelling
  - In-ground salt water pool, great for entertaining with enough room for outdoor setting and swivel umbrella
  - Foxtel connection throughout living spaces, home phone and 4G internet
  - Tennis court, cubby house and sandpit, vegetable garden, large chook shed and potting shed
  - 2 large 6,000 gallon tanks for house water plus two smaller tanks in the garden
  - Drastically cut monthly energy bills with stand alone 5KW solar system (48 panels, can be complete solar self sufficient)
  - A traditional timber, well maintained working 4 stand electric shearing shed with steel yards
  - 2x 80 t silos
  - 40' x 20' lockable car shed
  - 2 old sheds



The property is divided into 3 main paddocks with fencing being hinge joint. Approximately 90% arable self-mulching, black soil with scatted Belah, Pine, Box and Wilga. Watered by are 3 dams.

Services include mail 3 times a week with school bus at front gate.

The home is featured in this months (February) "Central West Lifestyle" Magazine

(More photos to come)

Inspection by appointment only.

This information has been obtained from our vendor(s) and third parties. We make no representations to its accuracy. All computer images, maps and photographs are indicative only. We are merely passing the information on. Interested parties should make their own enquiries.



Representative  
Jason Hartin

Property ID 3511416

Schute Bell  
Property



Sydney Office  
Ph: (02) 9892 0700  
www.schutebell.com.au

# . Glengarry Narromine, NSW

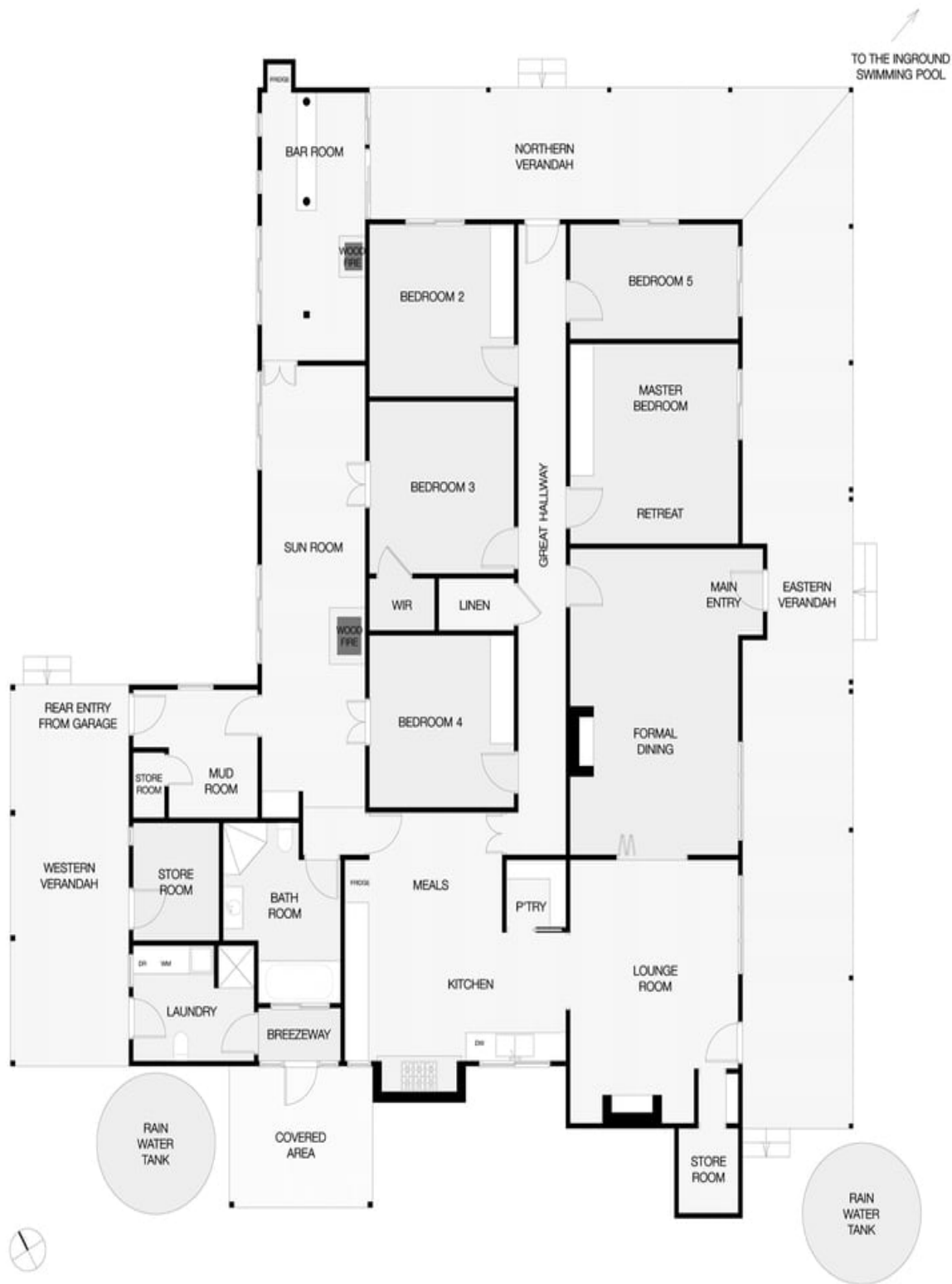

## "GLENGARRY" WYANGA ROAD, NARROMINE

PLAN DISCLAIMER: This diagram is for illustrative purposes only. All reasonable care has been taken in the preparation, but no warranty is given as to the accuracy of the information. This document does not constitute any part of any offer or contract. Any dimensions shown are approximate only. Prospective purchasers must rely on their own enquiries.

Plans prepared by Design Tribe Dubbo on behalf of the vendor.  
[www.designtribedubbo.com.au](http://www.designtribedubbo.com.au)